

38-47

# PLAT NO. 17 QUAIL RIDGE

(A PLANNED UNIT DEVELOPMENT)

IN SECTION 30 TOWNSHIP 45 SOUTH, RANGE 43 EAST  
PALM BEACH COUNTY, FLORIDA, BEING A REPLAT OF  
PORTIONS OF TRACTS 85,86,87,106,107,108,117 AND 118  
PALM BEACH FARMS COMPANY PLAT NO. 8 SEC. 30  
T-45-S, R-43-E PLAT BOOK 5 PAGE 73 AND OTHER LANDS

IN 3 SHEETS SHEET NO. 1

MOCK ROOS & SEARCY, INC.  
CONSULTING ENGINEERS  
WEST PALM BEACH, FLORIDA

JUNE 1978

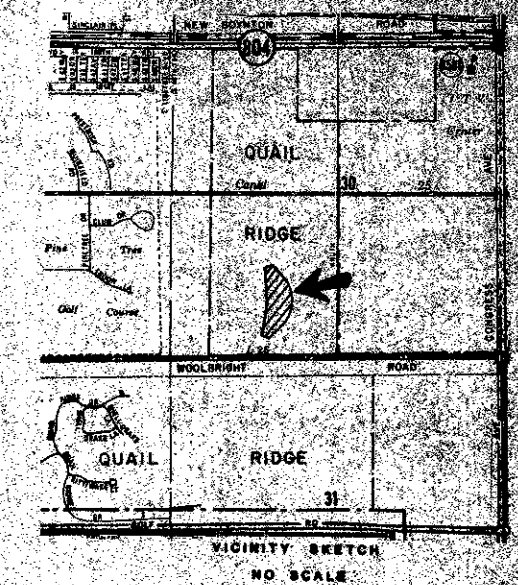

47

STATE OF FLORIDA  
COUNTY OF PALM BEACH  
THIS PLAN WAS FILED FOR RECORD  
ON 0-17-78 THIS 17 DAY OF  
SEPTEMBER 1978, AND DULY  
RECORDED IN PLAT BOOK NO. 3  
PAGES 11, 12, 13, 14, 15, 16, 17, 18, 19, 20, 21, 22, 23, 24, 25, 26, 27, 28, 29, 30, 31, 32, 33, 34, 35, 36, 37, 38, 39, 40, 41, 42, 43, 44, 45, 46, 47, 48, 49, 50, 51, 52, 53, 54, 55, 56, 57, 58, 59, 60, 61, 62, 63, 64, 65, 66, 67, 68, 69, 70, 71, 72, 73, 74, 75, 76, 77, 78, 79, 80, 81, 82, 83, 84, 85, 86, 87, 88, 89, 90, 91, 92, 93, 94, 95, 96, 97, 98, 99, 100, 101, 102, 103, 104, 105, 106, 107, 108, 109, 110, 111, 112, 113, 114, 115, 116, 117, 118, 119, 120, 121, 122, 123, 124, 125, 126, 127, 128, 129, 130, 131, 132, 133, 134, 135, 136, 137, 138, 139, 140, 141, 142, 143, 144, 145, 146, 147, 148, 149, 150, 151, 152, 153, 154, 155, 156, 157, 158, 159, 160, 161, 162, 163, 164, 165, 166, 167, 168, 169, 170, 171, 172, 173, 174, 175, 176, 177, 178, 179, 180, 181, 182, 183, 184, 185, 186, 187, 188, 189, 190, 191, 192, 193, 194, 195, 196, 197, 198, 199, 200, 201, 202, 203, 204, 205, 206, 207, 208, 209, 210, 211, 212, 213, 214, 215, 216, 217, 218, 219, 220, 221, 222, 223, 224, 225, 226, 227, 228, 229, 230, 231, 232, 233, 234, 235, 236, 237, 238, 239, 240, 241, 242, 243, 244, 245, 246, 247, 248, 249, 250, 251, 252, 253, 254, 255, 256, 257, 258, 259, 260, 261, 262, 263, 264, 265, 266, 267, 268, 269, 270, 271, 272, 273, 274, 275, 276, 277, 278, 279, 280, 281, 282, 283, 284, 285, 286, 287, 288, 289, 290, 291, 292, 293, 294, 295, 296, 297, 298, 299, 300, 301, 302, 303, 304, 305, 306, 307, 308, 309, 310, 311, 312, 313, 314, 315, 316, 317, 318, 319, 320, 321, 322, 323, 324, 325, 326, 327, 328, 329, 330, 331, 332, 333, 334, 335, 336, 337, 338, 339, 340, 341, 342, 343, 344, 345, 346, 347, 348, 349, 350, 351, 352, 353, 354, 355, 356, 357, 358, 359, 360, 361, 362, 363, 364, 365, 366, 367, 368, 369, 370, 371, 372, 373, 374, 375, 376, 377, 378, 379, 380, 381, 382, 383, 384, 385, 386, 387, 388, 389, 390, 391, 392, 393, 394, 395, 396, 397, 398, 399, 400, 401, 402, 403, 404, 405, 406, 407, 408, 409, 410, 411, 412, 413, 414, 415, 416, 417, 418, 419, 420, 421, 422, 423, 424, 425, 426, 427, 428, 429, 430, 431, 432, 433, 434, 435, 436, 437, 438, 439, 440, 441, 442, 443, 444, 445, 446, 447, 448, 449, 450, 451, 452, 453, 454, 455, 456, 457, 458, 459, 460, 461, 462, 463, 464, 465, 466, 467, 468, 469, 470, 471, 472, 473, 474, 475, 476, 477, 478, 479, 480, 481, 482, 483, 484, 485, 486, 487, 488, 489, 490, 491, 492, 493, 494, 495, 496, 497, 498, 499, 500, 501, 502, 503, 504, 505, 506, 507, 508, 509, 510, 511, 512, 513, 514, 515, 516, 517, 518, 519, 520, 521, 522, 523, 524, 525, 526, 527, 528, 529, 530, 531, 532, 533, 534, 535, 536, 537, 538, 539, 540, 541, 542, 543, 544, 545, 546, 547, 548, 549, 550, 551, 552, 553, 554, 555, 556, 557, 558, 559, 560, 561, 562, 563, 564, 565, 566, 567, 568, 569, 570, 571, 572, 573, 574, 575, 576, 577, 578, 579, 580, 581, 582, 583, 584, 585, 586, 587, 588, 589, 590, 591, 592, 593, 594, 595, 596, 597, 598, 599, 600, 601, 602, 603, 604, 605, 606, 607, 608, 609, 610, 611, 612, 613, 614, 615, 616, 617, 618, 619, 620, 621, 622, 623, 624, 625, 626, 627, 628, 629, 630, 631, 632, 633, 634, 635, 636, 637, 638, 639, 640, 641, 642, 643, 644, 645, 646, 647, 648, 649, 650, 651, 652, 653, 654, 655, 656, 657, 658, 659, 660, 661, 662, 663, 664, 665, 666, 667, 668, 669, 670, 671, 672, 673, 674, 675, 676, 677, 678, 679, 680, 681, 682, 683, 684, 685, 686, 687, 688, 689, 690, 691, 692, 693, 694, 695, 696, 697, 698, 699, 700, 701, 702, 703, 704, 705, 706, 707, 708, 709, 710, 711, 712, 713, 714, 715, 716, 717, 718, 719, 720, 721, 722, 723, 724, 725, 726, 727, 728, 729, 730, 731, 732, 733, 734, 735, 736, 737, 738, 739, 740, 741, 742, 743, 744, 745, 746, 747, 748, 749, 750, 751, 752, 753, 754, 755, 756, 757, 758, 759, 760, 761, 762, 763, 764, 765, 766, 767, 768, 769, 770, 771, 772, 773, 774, 775, 776, 777, 778, 779, 780, 781, 782, 783, 784, 785, 786, 787, 788, 789, 790, 791, 792, 793, 794, 795, 796, 797, 798, 799, 800, 801, 802, 803, 804, 805, 806, 807, 808, 809, 810, 811, 812, 813, 814, 815, 816, 817, 818, 819, 820, 821, 822, 823, 824, 825, 826, 827, 828, 829, 830, 831, 832, 833, 834, 835, 836, 837, 838, 839, 840, 841, 842, 843, 844, 845, 846, 847, 848, 849, 850, 851, 852, 853, 854, 855, 856, 857, 858, 859, 860, 861, 862, 863, 864, 865, 866, 867, 868, 869, 870, 871, 872, 873, 874, 875, 876, 877, 878, 879, 880, 881, 882, 883, 884, 885, 886, 887, 888, 889, 890, 891, 892, 893, 894, 895, 896, 897, 898, 899, 900, 901, 902, 903, 904, 905, 906, 907, 908, 909, 910, 911, 912, 913, 914, 915, 916, 917, 918, 919, 920, 921, 922, 923, 924, 925, 926, 927, 928, 929, 930, 931, 932, 933, 934, 935, 936, 937, 938, 939, 940, 941, 942, 943, 944, 945, 946, 947, 948, 949, 950, 951, 952, 953, 954, 955, 956, 957, 958, 959, 960, 961, 962, 963, 964, 965, 966, 967, 968, 969, 970, 971, 972, 973, 974, 975, 976, 977, 978, 979, 980, 981, 982, 983, 984, 985, 986, 987, 988, 989, 990, 991, 992, 993, 994, 995, 996, 997, 998, 999, 1000

DESCRIPTION  
BEING IN THE MOST WESTERLY CORNER OF PLAT NO. 17, QUAIL RIDGE, AS SHOWN ON THE PLAT THEREOF, BEING IN PLAT BOOK 5, PAGES 73 AND 74, PUBLIC RECORDS OF PALM BEACH COUNTY, FLORIDA, BEING A REPLAT OF PORTIONS OF TRACTS 85, 86, 87, 106, 107, 108, 117 AND 118 PALM BEACH FARMS COMPANY PLAT NO. 8 SEC. 30 T-45-S, R-43-E PLAT BOOK 5 PAGE 73 AND OTHER LANDS CONTAINING 14.21 ACRES, MORE OR LESS.

### DEDICATION

KNOW ALL MEN BY THESE PRESENTS THAT QUAIL RIDGE, LTD., A FLORIDA LIMITED PARTNERSHIP, OWNERS OF THE LAND SHOWN HEREON, BEING IN SECTION 30, TOWNSHIP 45 SOUTH, RANGE 43 EAST, PALM BEACH COUNTY, FLORIDA, SHOWN HEREON AS PLAT NO. 17, QUAIL RIDGE AND BEING MORE PARTICULARLY DESCRIBED HEREON HAVE CAUSED THE SAME TO BE SURVEYED AND PLATTED AS SHOWN HEREON AND DO HEREBY DEDICATE AS FOLLOWS:

- 1) THE UTILITY EASEMENTS AND DRAINAGE EASEMENTS AS SHOWN ARE HEREBY DEDICATED IN PERPETUITY FOR THE CONSTRUCTION AND MAINTENANCE OF UTILITIES AND DRAINAGE, AND ARE THE PERPETUAL MAINTENANCE OBLIGATION OF THE QUAIL RIDGE PROPERTY OWNERS' ASSOCIATION, INC.
- 2) THE LANEWAY ACCESS EASEMENT AS SHOWN IS DEDICATED TO THE BOARD OF COUNTY COMMISSIONERS OF PALM BEACH COUNTY, FLORIDA, FOR THE PURPOSES OF CONTROL AND JURISDICTION OVER ACCESS RIGHTS.

IN WITNESS WHEREOF, THE SAID LIMITED PARTNERSHIP HAS CAUSED THESE PRESENTS TO BE SIGNED BY JOHN S. DODGE, PRESIDENT, AND ATTESTED BY JOHN D. MCKEY, JR., SECRETARY, OF QUAIL RIDGE, INC., A FLORIDA CORPORATION, THE GENERAL PARTNER OF QUAIL RIDGE, INC., AND ITS CORPORATE SEAL TO BE AFFIXED HERETO BY AND WITH THE AUTHORITY OF ITS BOARD OF DIRECTORS THIS 14th DAY OF August, A.D., 1978.

QUAIL RIDGE, INC.  
ATTEST: *John S. Dodge* PRESIDENT  
*John D. McKey, Jr.* SECRETARY

### ACKNOWLEDGMENT

STATE OF FLORIDA )  
COUNTY OF PALM BEACH )  
BEFORE ME PERSONALLY APPEARED JOHN S. DODGE AND JOHN D. MCKEY, JR., TO ME WELL KNOWN AND KNOWN TO ME TO BE THE INDIVIDUALS DESCRIBED IN AND WHO EXECUTED THE FOREGOING INSTRUMENT AS PRESIDENT AND SECRETARY OF THE ABOVE NAMED QUAIL RIDGE, INC., A CORPORATION, WHICH IS GENERAL PARTNER OF QUAIL RIDGE, LTD., AND SEVERALLY ACKNOWLEDGED TO AND BEFORE ME THAT THEY EXECUTED SUCH INSTRUMENT AS SUCH PRESIDENT AND SECRETARY RESPECTIVELY OF SAID CORPORATION, AND THAT THE SEAL AFFIXED TO THE FOREGOING INSTRUMENT IS THE CORPORATE SEAL OF SAID CORPORATION AND THAT IT WAS AFFIXED TO SAID INSTRUMENT BY THE REGULAR CORPORATE AUTHORITY AND THAT SAID INSTRUMENT IS THE FREE ACT AND DEED OF SAID CORPORATION, ACTING AS GENERAL PARTNER OF QUAIL RIDGE, LTD.

WITNESS MY HAND AND OFFICIAL SEAL, THIS 14th DAY OF August, A.D., 1978.  
*James C. Moore*  
NOTARY PUBLIC  
MY COMMISSION EXPIRES Aug 1, 1980

### MORTGAGEE'S CONSENT

STATE OF FLORIDA )  
COUNTY OF DUVAL )  
THE UNDERSIGNED HEREBY CERTIFIES THAT IT IS THE HOLDER OF A MORTGAGE LIEN UPON THE HEREIN DESCRIBED PROPERTY AND DOES HEREBY JOIN IN AND CONSENT TO THE DEDICATION HERETO BY THE OWNER THEREOF AND AGREES THAT ITS MORTGAGE LIEN DATED MAY 27, 1977, WHICH IS RECORDED IN OFFICIAL RECORD BOOK 2591, PAGE 1897, PUBLIC RECORDS OF PALM BEACH COUNTY, FLORIDA, SHALL BE SUBORDINATED TO THE DEDICATION SHOWN HEREIN.

IN WITNESS WHEREOF, THE UNDERSIGNED CORPORATION HAS CAUSED THESE PRESENTS TO BE SIGNED BY ITS PRESIDENT/VICE PRESIDENT, ATTESTED BY ITS SECRETARY/ASSISTANT SECRETARY, AND ITS CORPORATE SEAL TO BE AFFIXED HERETO BY AND WITH THE AUTHORITY OF ITS BOARD OF DIRECTORS THIS 21st DAY OF August, A.D., 1978.

WITNESS MY HAND AND OFFICIAL SEAL, THIS 21st DAY OF August, A.D., 1978.  
*James C. Moore*  
NOTARY PUBLIC  
MY COMMISSION EXPIRES 6-30-78

### ACKNOWLEDGMENT

STATE OF FLORIDA )  
COUNTY OF DUVAL )  
BEFORE ME PERSONALLY APPEARED *W. A. Sater*, TO ME WELL KNOWN, AND KNOWN TO ME TO BE THE INDIVIDUAL WHO EXECUTED THE FOREGOING INSTRUMENT AS THE AUTHORIZED REPRESENTATIVE OF THE ABOVE NAMED TRUSTEES OF COMPASS INVESTMENT GROUP, AND ACKNOWLEDGED TO AND BEFORE ME THAT HE EXECUTED SUCH INSTRUMENT AS SUCH AUTHORIZED REPRESENTATIVE.

WITNESS MY HAND AND OFFICIAL SEAL, THIS 14th DAY OF August, A.D., 1978.  
*Donald Curtis*  
NOTARY PUBLIC  
MY COMMISSION EXPIRES April 20, 1983

### MORTGAGEE'S CONSENT

STATE OF FLORIDA )  
COUNTY OF PALM BEACH )  
THE UNDERSIGNED HEREBY CERTIFIES THAT IT IS THE HOLDER OF A MORTGAGE LIEN UPON THE HEREIN DESCRIBED PROPERTY AND DOES HEREBY JOIN IN AND CONSENT TO THE DEDICATION HERETO BY THE OWNER THEREOF AND AGREES THAT ITS MORTGAGE LIEN DATED SEPTEMBER 30, 1976, WHICH IS RECORDED IN OFFICIAL RECORD BOOK 2591, PAGE 1822 OF THE PUBLIC RECORDS OF PALM BEACH COUNTY, FLORIDA, SHALL BE SUBORDINATED TO THE DEDICATION SHOWN HEREIN.

IN WITNESS WHEREOF, THE UNDERSIGNED CORPORATION HAS CAUSED THESE PRESENTS TO BE SIGNED BY ITS PRESIDENT/VICE PRESIDENT, ATTESTED BY ITS SECRETARY/ASSISTANT SECRETARY, AND ITS CORPORATE SEAL TO BE AFFIXED HERETO BY AND WITH THE AUTHORITY OF ITS BOARD OF DIRECTORS THIS 21st DAY OF August, A.D., 1978.

FIRST FEDERAL SAVINGS AND LOAN ASSOCIATION OF DELRAY BEACH  
ATTEST: *James C. Moore* SECRETARY  
*James C. Moore* PRESIDENT

### ACKNOWLEDGMENT

STATE OF FLORIDA )  
COUNTY OF PALM BEACH )  
BEFORE ME PERSONALLY APPEARED *James C. Moore*, TO ME WELL KNOWN, AND KNOWN TO ME TO BE THE INDIVIDUAL WHO EXECUTED THE FOREGOING INSTRUMENT AS PRESIDENT AND SECRETARY OF THE ABOVE NAMED FIRST FEDERAL SAVINGS AND LOAN ASSOCIATION OF DELRAY BEACH, A CORPORATION, AND SEVERALLY ACKNOWLEDGED TO AND BEFORE ME THAT THEY EXECUTED SUCH INSTRUMENT AS SUCH PRESIDENT/VICE PRESIDENT AND SECRETARY/ASSISTANT SECRETARY, RESPECTIVELY, OF SAID CORPORATION, AND THAT THE SEAL AFFIXED TO THE FOREGOING INSTRUMENT IS THE CORPORATE SEAL OF SAID CORPORATION AND THAT IT WAS AFFIXED TO SAID INSTRUMENT BY THE REGULAR CORPORATE AUTHORITY, AND THAT SAID INSTRUMENT IS THE FREE ACT AND DEED OF SAID CORPORATION.

WITNESS MY HAND AND OFFICIAL SEAL, THIS 21st DAY OF August, A.D., 1978.  
*James C. Moore*  
NOTARY PUBLIC  
MY COMMISSION EXPIRES 6-30-78

### MORTGAGEE'S CONSENT

STATE OF FLORIDA )  
COUNTY OF PALM BEACH )  
THE UNDERSIGNED HEREBY CERTIFIES THAT IT IS THE HOLDER OF A MORTGAGE LIEN UPON THE HEREIN DESCRIBED PROPERTY AND DOES HEREBY JOIN IN AND CONSENT TO THE DEDICATION HERETO BY THE OWNER THEREOF AND AGREES THAT ITS MORTGAGE LIEN DATED OCTOBER 1, 1976, AND RECORDED IN OFFICIAL RECORD BOOK 2591, PAGE 1897, PUBLIC RECORDS OF PALM BEACH COUNTY, FLORIDA, SHALL BE SUBORDINATED TO THE DEDICATION SHOWN HEREIN.

IN WITNESS WHEREOF, RICHARD FRISBEE, MARIE T. GRADY, CLIFTON W. RAND, LLOYD GREINER, JOHN BILTHUIS, ARTHUR HEINIS, RICHARD JOHNSTON, J. ALLEN MACLEAN, WILLIAM GERTWICKER AND ANN S. GERTWICKER, HIS WIFE, WILLIAM STICKNEY, HOWARD SEEL, AND JOHN GOODING HAVE CAUSED THESE PRESENTS TO BE SIGNED BY JOHN D. MCKEY, JR., THEIR LAWFUL ATTORNEY-IN-FACT, THIS 16th DAY OF August, 1978.

WITNESS: *James C. Moore* BY *John D. McKey, Jr.*  
JOHN D. MCKEY, JR.  
ATTORNEY-IN-FACT  
O.R. BOOK 2028, PAGES 995-610  
PUBLIC RECORDS OF PALM BEACH COUNTY, FLORIDA.

### ACKNOWLEDGMENT

STATE OF FLORIDA )  
COUNTY OF PALM BEACH )  
BEFORE ME PERSONALLY APPEARED JOHN D. MCKEY, JR., TO ME WELL KNOWN, AND KNOWN TO ME TO BE THE INDIVIDUAL WHO EXECUTED THE FOREGOING INSTRUMENT AS THE LAWFUL ATTORNEY-IN-FACT FOR THE ABOVE-NAMED PERSONS, AND ACKNOWLEDGED TO AND BEFORE ME THAT HE EXECUTED SUCH INSTRUMENT AS SUCH AUTHORIZED REPRESENTATIVE.

WITNESS MY HAND AND OFFICIAL SEAL, THIS 18th DAY OF August, A.D., 1978.  
*James C. Moore*  
NOTARY PUBLIC  
MY COMMISSION EXPIRES Aug 1, 1980

### TITLE CERTIFICATION

STATE OF FLORIDA )  
COUNTY OF PALM BEACH )  
I, JOHN D. MCKEY, JR., A DULY LICENSED ATTORNEY IN THE STATE OF FLORIDA, DO HEREBY CERTIFY THAT I HAVE EXAMINED THE TITLE TO THE HEREON DESCRIBED PROPERTY; THAT I FIND THE TITLE TO THE PROPERTY IS VESTED TO QUAIL RIDGE, LTD.; THAT THE CURRENT TAXES HAVE BEEN PAID; AND THAT I FIND THAT THE PROPERTY IS ENCUMBERED BY THE MORTGAGES SHOWN HEREON; AND THAT I FIND THAT ALL MORTGAGES ARE SHOWN AND ARE TRUE AND CORRECT.

WITNESS MY HAND AND OFFICIAL SEAL, THIS 18th DAY OF August, A.D., 1978.  
*John D. McKey, Jr.*  
JOHN D. MCKEY, JR.

### MORTGAGEE'S CONSENT

STATE OF FLORIDA )  
COUNTY OF PALM BEACH )  
THE UNDERSIGNED HEREBY CERTIFIES THAT IT IS THE HOLDER OF A MORTGAGE LIEN UPON THE HEREIN DESCRIBED PROPERTY AND DOES HEREBY JOIN IN AND CONSENT TO THE DEDICATION HERETO BY THE OWNER THEREOF AND AGREES THAT ITS MORTGAGE LIEN DATED SEPTEMBER 30, 1976, WHICH IS RECORDED IN OFFICIAL RECORD BOOK 2591, PAGE 1837 OF THE PUBLIC RECORDS OF PALM BEACH COUNTY, FLORIDA, SHALL BE SUBORDINATED TO THE DEDICATION SHOWN HEREIN.

IN WITNESS WHEREOF, THE UNDERSIGNED CORPORATION HAS CAUSED THESE PRESENTS TO BE SIGNED BY ITS PRESIDENT/VICE PRESIDENT, ATTESTED BY ITS SECRETARY/ASSISTANT SECRETARY, AND ITS CORPORATE SEAL TO BE AFFIXED HERETO BY AND WITH THE AUTHORITY OF ITS BOARD OF DIRECTORS THIS 21st DAY OF August, 1978.

FIRST AFFILIATE, INC., A FLORIDA CORPORATION  
ATTEST: *James C. Moore* SECRETARY  
*James C. Moore* PRESIDENT

### ACKNOWLEDGMENT

STATE OF FLORIDA )  
COUNTY OF PALM BEACH )  
BEFORE ME PERSONALLY APPEARED *James C. Moore*, TO ME WELL KNOWN, AND KNOWN TO ME TO BE THE INDIVIDUAL WHO EXECUTED THE FOREGOING INSTRUMENT AS PRESIDENT/VICE PRESIDENT AND SECRETARY/ASSISTANT SECRETARY OF THE ABOVE NAMED FIRST AFFILIATE, INC., A FLORIDA CORPORATION, AND SEVERALLY ACKNOWLEDGED TO AND BEFORE ME THAT THEY EXECUTED SUCH INSTRUMENT AS SUCH PRESIDENT/VICE PRESIDENT AND SECRETARY/ASSISTANT SECRETARY, RESPECTIVELY, OF SAID CORPORATION, AND THAT THE SEAL AFFIXED TO THE FOREGOING INSTRUMENT IS THE CORPORATE SEAL OF SAID CORPORATION AND THAT IT WAS AFFIXED TO SAID INSTRUMENT BY THE REGULAR CORPORATE AUTHORITY, AND THAT SAID INSTRUMENT IS THE FREE ACT AND DEED OF SAID CORPORATION.

WITNESS MY HAND AND OFFICIAL SEAL, THIS 21st DAY OF August, A.D., 1978.  
*James C. Moore*  
NOTARY PUBLIC  
MY COMMISSION EXPIRES 6-30-78

### SURVEYOR'S CERTIFICATE

THIS IS TO CERTIFY THAT THE PLAN SHOWN HEREON IS A TRUE AND CORRECT REPRESENTATION OF A SURVEY MADE UNDER MY RESPONSIBILITY AND SUPERVISION AND THAT SAID SURVEY IS ACCURATE TO THE BEST OF MY SKILL AND BEST KNOWLEDGE AND THAT (F.S. 17) PERMANENT REFERENCE MONUMENTS HAVE BEEN PLACED AS REQUIRED BY LAW AND FURTHER THAT THE SURVEY DATA COMPLETES WITH ALL THE REQUIREMENTS OF CHAPTER 170, FLORIDA STATUTES, PART 1, AS AMENDED, AND ORDINANCES OF PALM BEACH COUNTY, FLORIDA.

WITNESS MY HAND AND OFFICIAL SEAL, THIS 21st DAY OF August, A.D., 1978.  
*James C. Moore*  
REGISTERED SURVEYOR NO. 1552  
STATE OF FLORIDA 2-27-79

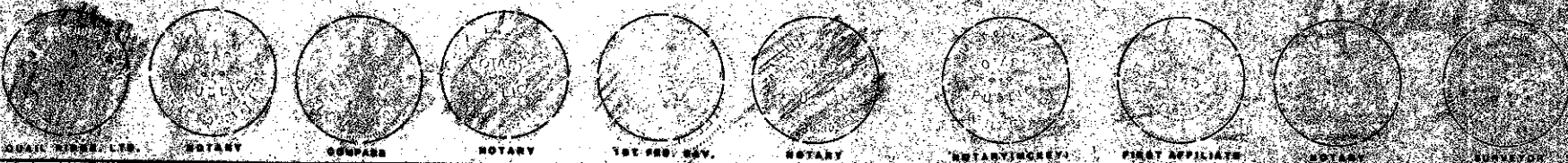

THIS INSTRUMENT WAS PREPARED BY  
HOWARD  
MOCK ROOS & SEARCY, INC.  
CONSULTING ENGINEERS  
3214 DRECHOWER BOULEVARD  
WEST PALM BEACH, FLORIDA 33409